

A basalt floor will be even more perfect when the detail of the connection of the wall and the floor is solved. For this purpose we manufacture several different L-pieces or covered tiles. L-pieces are used as a perfect connection of the floor with the wall. It is an interesting element, not only functionally, but also from a design point of view.

This solution can be used in the interior of a family home or restaurant, in production halls or warehouses, in food-processing operations and many other places. It makes cleaning the floor much easier. The radius in the corner of the L-piece contributes to good cleaning of the entire floor and thus to better hygiene.

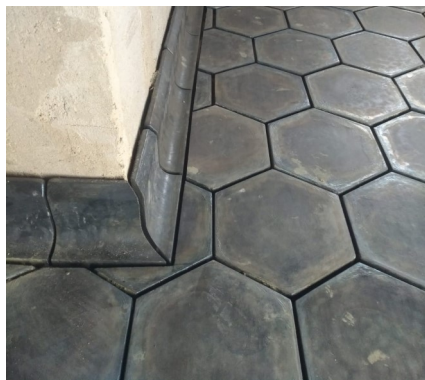

Manufactured Types of L-pieces

L = 200 mm

Typ 0003993

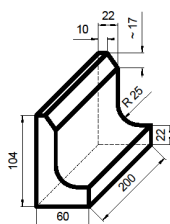

Typ 0022817

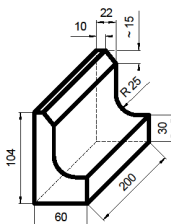

Typ 0000156

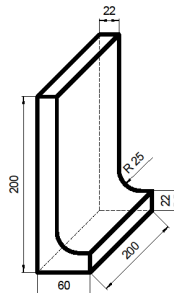

Typ 0002025

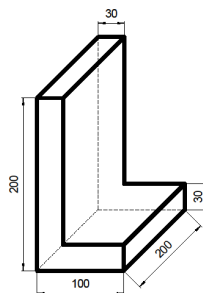

Typ 0004888

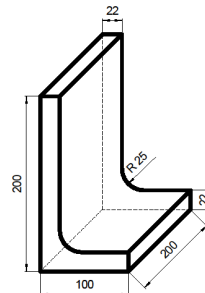

Typ 0004889

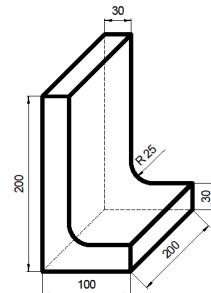

L = 250 mm

Typ 0005014

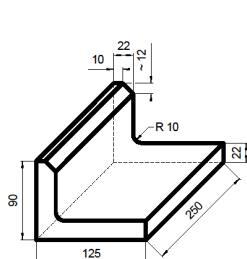

Typ 0025414

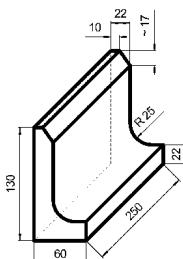

Typ 0002757

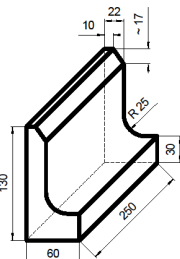

Typ 0000157

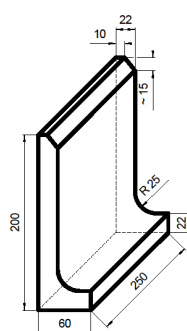

Typ 0000158

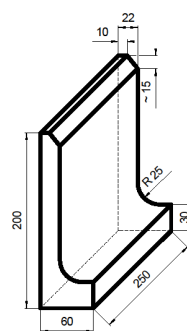

Typ 0002994

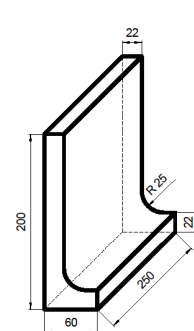

Coved Strips

Typ 0025587 L=200 mm
Typ 0025541 L=250 mm



Curb Shape Piece

Typ 0014767

